

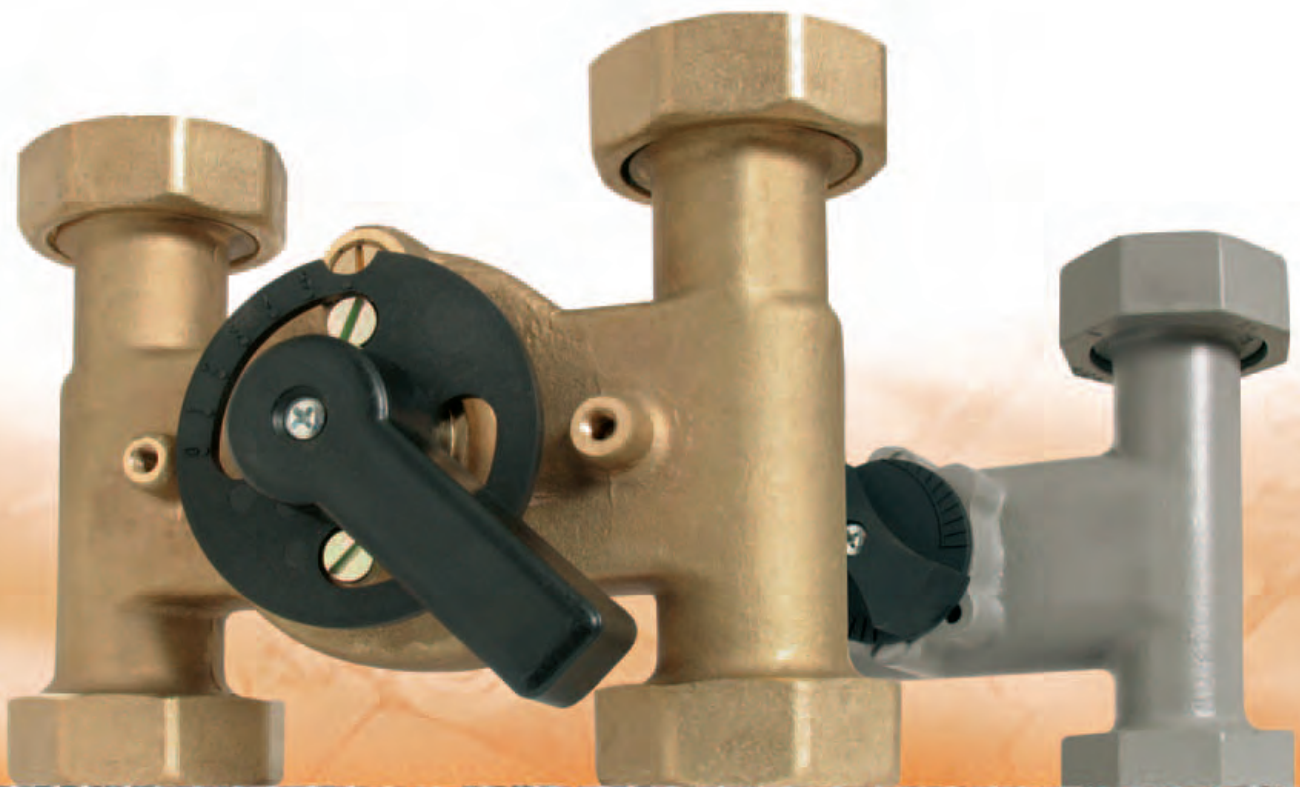

MIXING TECHNOLOGY

H mixers







WILHELM TAAKE GMBH Pumpen-, Armaturen- und Regeltechnik
Böllingshöfen 85 · D-32549 Bad Oeynhausen
Tel.: +49 (0) 57 34-5123 80 · Fax: +49 (0) 57 34-17 52
Internet: <http://www.wita-taake.de> · e-mail: info@wita-taake.de



WITA has been supplying technically mature equipment for more than 40 years. We can supply all the equipment you need for a modern heating system.

Our product range includes

-  Mixing Technology
-  Pump technology
-  Control technology
-  Drive technology
-  Fitting technology

Mixing Technology

The H range of WITA mixers are suitable for smaller to medium-sized warm water heating systems. They can be used for manual or motor control.

The compact mixers are available in both 3 way and 4 way versions. The centre distance ranges between 90 mm and 125 mm depending on the mixer type. The casing is made of grey cast iron or brass. The cover, drive shaft and lid are made of brass.

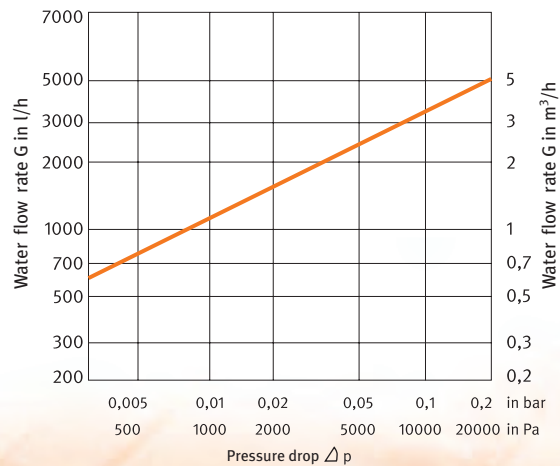

Motor drive

The H range of WITA mixers can also be motor driven. The central arrangement of the fastening points enables the simple attachment of a controller. They form a compact unit combined with the WITA SM4 servomotor.

MIXING TECHNOLOGY

H 6 | H 10

H mixers

The H 6 and H 10 mixing valves have parallel connections for supply and return (heater side at the top with flange - boiler side at the bottom with G 1 1/2" thread). The supply and return flows are interchangeable. The equipment is delivered with supply from the right. The mixing valves guarantee linear temperature

control through specially profiled inlets and outlets. The central arrangement of the fastening points enables the simple attachment of a controller.

The mixers are equipped with an infinitely adjustable bypass slide valve for low temperature heating systems.

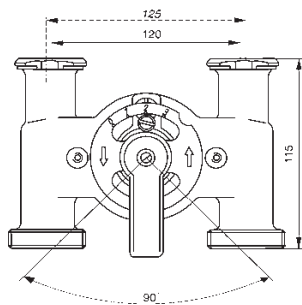

H 6

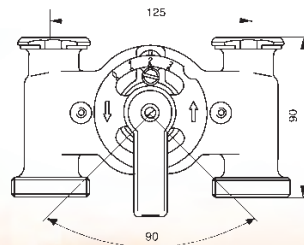

H 10

Technical specifications

H 6

H 10

Centre distance:	120 or 125 mm	120 mm
Height of construction:	115 mm	90 mm
Connection on the boiler side:	G 1 1/2"	G 1 1/2"
Connection on the heating side:	Pump flange	Pump flange
Casing:	Brass	Brass
Spindle seals:	two O rings	two O rings
Torque:	0,3 Nm	0,3 Nm
Adjustment range:	90°	90°
Max. operating pressure:	10 bar	10 bar
Max. operating temperature:	110°C	110°C
Supply limitation:	Bypass	Bypass

H 9 GG | H 9 Ms

H mixers

The H 9 3 and 4 way compact mixers are suitable for smaller and medium-sized warm water central heating systems. They can be used for manual or motor control. They form a compact unit combined with the SM4 servomotor. The connection spacing between supply and return is 120 mm. The mixing valve casing, cover, drive shaft and lid are made of brass. Specially

profiled outlets guarantee linear temperature characteristics. Two EPDM O rings seal the shaft. In the case of the 3 and 4 way mixers, the supply side is variable. The equipment is delivered with boiler supply from the right.

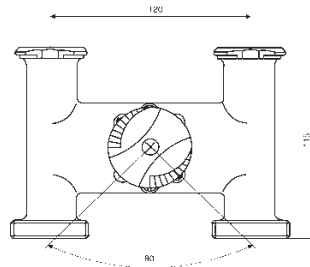

H 9 GG | H 9 Ms



Technical specifications

H 9 GG

H 9 Ms

Centre distance:	120 mm	120 mm
Height of construction:	115 mm	115 mm
Connection on the boiler side:	G 1 ½"	G 1 ½"
Connection on the heating side:	Pump flange	Pump flange
Casing:	Grey cast iron GG25	Brass
Spindle seals:	two O rings	two O rings
Torque:	0,3 Nm	0,3 Nm
Adjustment range:	90°	90°
Max. operating pressure:	10 bar	10 bar
Max. operating temperature:	110°C	110°C

MIXING TECHNOLOGY

Function

The WITA mixers H 6, H 9 and H 10 combines hot boiler supply water with the colder water flowing back from the radiators to produce a common heating supply. The

ensuing supply temperature is dependent on the mixing ratio and, as such, on the setting of the rotating slide valve.

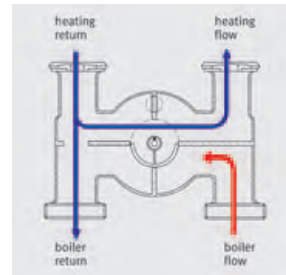
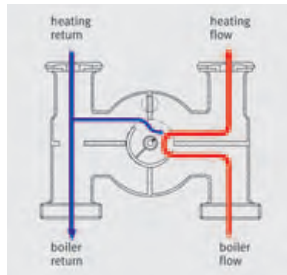
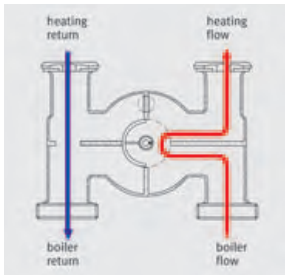

3 way

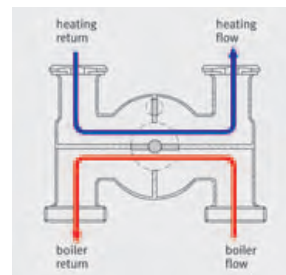
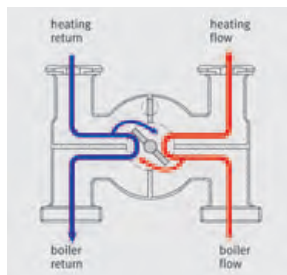
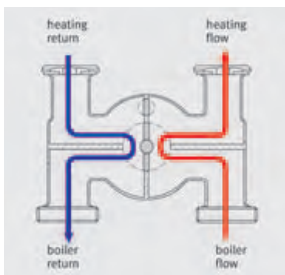

4 way

Bypass

The H 6 and H 10 mixers are equipped with a bypass flap for low temperature heating systems (floor heating). This adjustable bypass flap is located between the heating supply and return. This ensures

optimal control of the supply temperature, even in low temperature heating systems, due to the full utilisation of the mixing valve adjustment range of 90°.

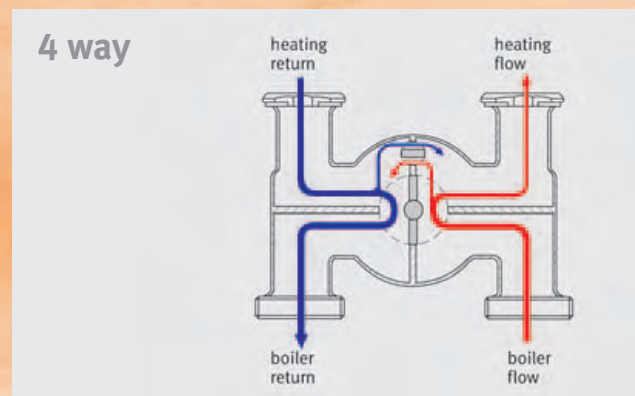
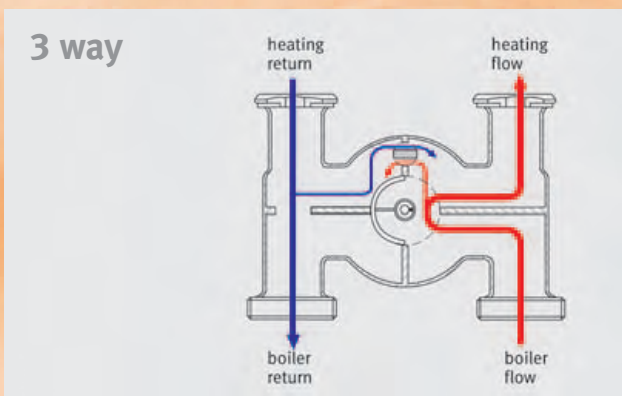

Technical specifications

	H 6	H 9 GG	H 9 Ms	H 10
Centre distance:	120 or 120 mm	120 mm	120 mm	120 mm
Height of construction:	120 mm	115 mm	115 mm	90 mm
Connection on the boiler side:	G 1½"	G 1½"	G 1½"	G 1½"
Connection on the heating side:	Pump flange	Pump flange	Pump flange	Pump flange
Casing:	Brass	Grey cast iron GG25	Brass	Brass
Spindle seals:	two O rings	two O rings	two O rings	two O rings
Torque:	0,3 Nm	0,3 Nm	0,3 Nm	0,3 Nm
Adjustment range::	90°	90°	90°	90°
Max. operating pressure:	110°C	110°C	110°C	110°C
Max. operating temperature:	10 bar	10 bar	10 bar	10 bar
Supply limitation:	Bypass			Bypass

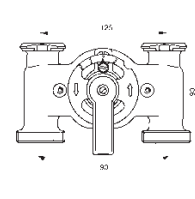
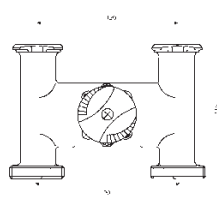
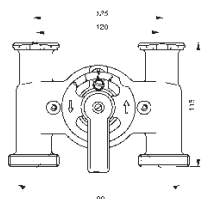

RANGE OF MIXERS

	Type of mixer	Art. no.	with bypass	Height	Centre distance
 WITA H 6	H 6, 3 way 1"	A 55 100	•	115 mm	120 mm
	H 6, 4 way 1"	A 56 100	•	115 mm	120 mm
	H 6, 3 way 1"	A 55 200	•	115 mm	125 mm
	H 6, 4 way 1"	A 56 200	•	115 mm	125 mm
 WITA H 9	H 9, 3 way 1" (grey cast iron)	M 90 100	–	115 mm	120 mm
	H 9, 3 way 1" (brass)	M 91 100	–	115 mm	120 mm
	H 9, 4 way 1" (grey cast iron)	M 90 200	–	115 mm	120 mm
	H 9, 4 way 1" (brass)	M 91 200	–	115 mm	120 mm
 WITA H 10	H 10, 3 way 1"	M 92 100	•	90 mm	125 mm
	H 10, 4 way 1"	M 92 200	•	90 mm	125 mm

Other connections are available on request.