



DRIVE TECHNOLOGY

Servomotors



WILHELM TAAKE GMBH Pumpen-, Armaturen- und Regeltechnik
Böllingshöfen 85 · D-32549 Bad Oeynhausen
Tel.: +49 (0) 57 34-5123 80 · Fax: +49 (0) 57 34-17 52
Internet: <http://www.wita-taake.de> · e-mail: info@wita-taake.de

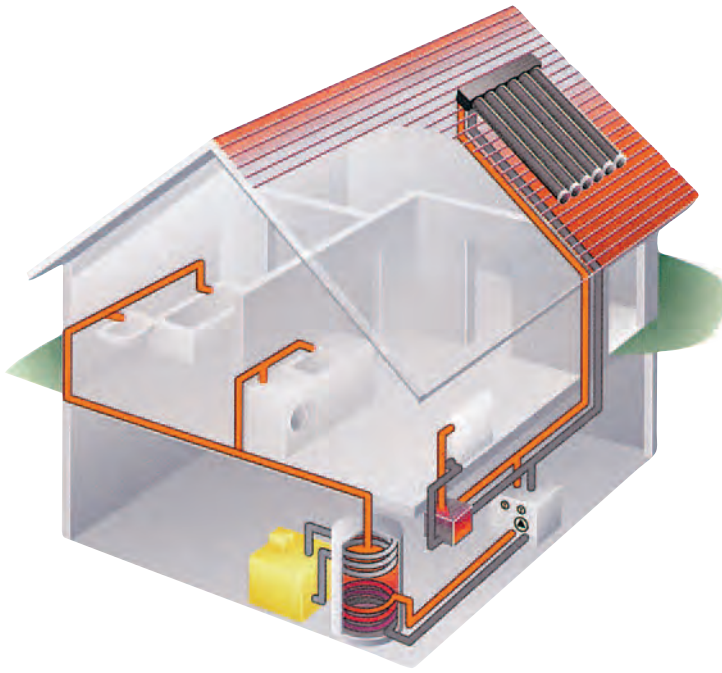

WITA has been supplying technically mature equipment for more than 40 years. We can supply all the equipment you need for a modern heating system.

Our product range includes

- ◆ Drive technology
- ◆ Mixing Technology
- ◆ Pump technology
- ◆ Control technology
- ◆ Fitting technology

Drive technology

WITA servomotors are compact and sturdy. The cover hood accommodates a small encapsulated gearing that is maintenance-free and a reversible

synchronous motor. The servomotors are connected by means of a pre-assembled connecting cable or connecting terminals in the casing, depending on the model.

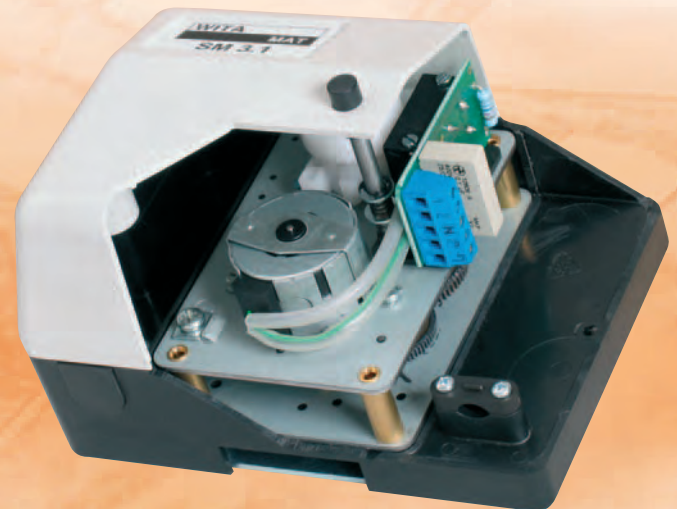

DRIVE TECHNOLOGY

SM 3

Servomotor

The servomotors in the SM 3 range are particularly suitable for use in heating and air conditioning systems and are operated using a three-point controller or change-over contacts. They are compact and sturdy.



Technical specifications

- available with 10 Nm torque
- available with 230 V ~ 50 Hz or 24 V ~ 50 Hz
- adjustable cam for different setting angles (in 15° increments)
- easy to fit on different brands of mixers with the aid of special assembly kits and adjustable claws
- disengaging dog for manual adjustment
- available with pre-assembled potential-free 3. limit switch (infinitely adjustable) on request
- available with connecting cables for the operating voltage and 3. limit switch on request

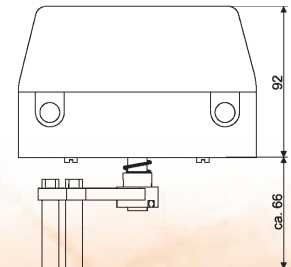
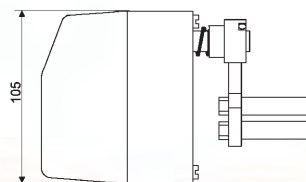
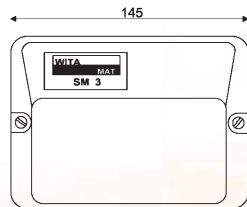

Technical specifications SM 3

Torque:	10 Nm anti-blocking (higher torques available on request)
Operating voltage:	230V 50/60 Hz, 2,3VA or 24V 50/60 Hz, 1,6 VA
Protection type:	IP51
Protection class:	I
Adjustment range:	15° -345° (in 15° increments)
Adjusting times for 90° angle:	130 s, 210 s
Connection:	Connecting terminal

Note: Please consult the data sheet of the mixer to be installed (torque) when selecting a servomotor!



SM 4.6 | SM 4.10

Servomotor

The SM 4 series of servomotors compactly designed and suitable for universal use on various mixers.

Technical specifications

- deliverable in two various torques (SM 4.6 = 6 Nm and SM 4.10 = 10 Nm)
- maintenance-free, encapsulated gearing
- 90° setting angle (fixed on SM 4.6 at 6 Nm)
- adjustable cam for different setting angles (in 15° increments on SM 4 at 10 Nm)
- 2 m connecting cables for the operating voltage and 3. limit switch on request
- Manual adjustment
- Manual adjusting button with scale for setting display
- centric assembly
- available with pre-assembled potential-free 3. limit switch (adjustable in 15° increments) with connecting cable (SM 4.10 and SM 4.10 R only) on request
- available with 230 V ~ 50 Hz or 24 V ~ 50 Hz



Note:

Please consult the data sheet of the mixer to be installed (torque) when selecting a servomotor!

Technical specifications	SM 4.6	SM 4.10
Torque:	6 Nm max. (anti-blocking BL 240h) at operating time 150 sec.	10 Nm max. (anti-blocking BL 240h)
Operating voltage:	230 V ~ 50Hz/60Hz, 2,3 VA or 24 V ~ 50Hz/60Hz, 1,6 VA	230 V ~ 50Hz/60Hz, 2,3 VA or 24 V ~ 50Hz/60Hz, 1,6 VA
Protection type:	IP 40	IP40
Protection class:	II	II
Adjustment range:	90° (fixed cams)	90° (in 15° increments adjustable)
Setting times	60 sec./90°, 150 sec./90°, 210 sec. / 90°	150 sec./90°, 210 sec. / 90°
Connection:	2 m connecting cable 3 x 0,75 mm ² pre-wired	2 m connecting cable 3 x 0,75 mm ² pre-wired or connecting terminal on request

SM 4.10 R

Servomotor

The SM 4.10 R series of servomotors offer the same features as the SM 4 servomotors.

They are used in areas where, for example, a mixer acts as a valve. The supply and control voltage is 230 V~ or 24 V~, depending on the model. A 2-point controller, thermostats or on/off switches can be used to switch the control voltage.



Note:

Please consult the data sheet of the mixer to be installed (torque) when selecting a servomotor!

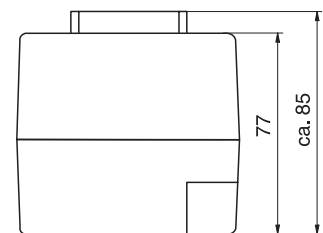
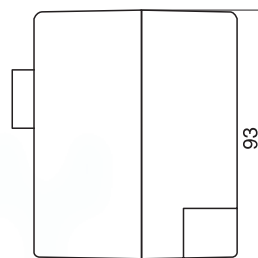
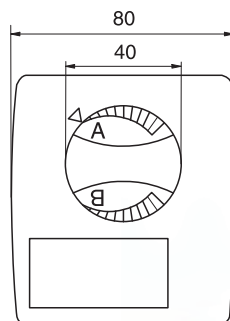

Technical specifications

SM 4.10 R

Torque:	10 Nm max. (anti-blocking BL 240h)
Operating voltage:	230 V ~ 50 Hz/60 Hz, 2,3 VA or 24 V ~ 50 Hz/60 Hz, 1,6 VA
Protection type:	IP 40
Protection class:	II
Adjustment range:	90° (adjustable in 15° increments)
Setting times	150 sec./90°, 210 sec./90°
Connection:	2 m connecting cable 3 x 0,75 mm ² pre-wired

SM 5

Servomotor

The SM 5 series of servomotors compactly designed and suitable for universal use on various mixers.



Technical specifications

- various torques (6 Nm and 10 Nm)
- available with 230 V ~ 50 Hz and 24 V ~ 50/60 Hz
- various operating times
- various setting angles (standard is 90°, other angles available on request)
- maintenance-free, encapsulated gearing
- special assembly kits for easy mounting on different brands of mixers
- Manual adjustment
- available with pre-assembled potential-free 3. limit switch (infinitely adjustable) on request

Note:

Please consult the data sheet of the mixer to be installed (torque) when selecting a servomotor!

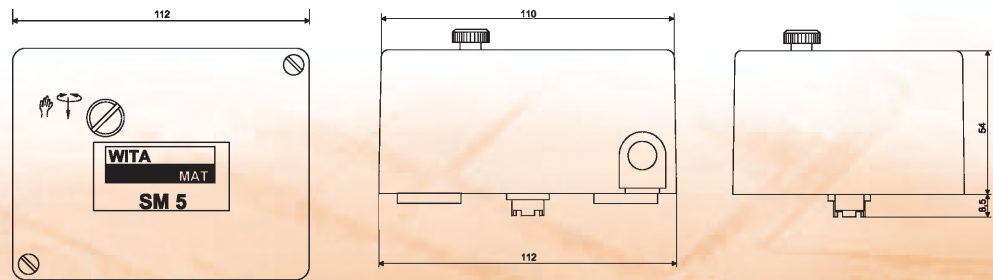

Technical specifications SM 5

Torque:	max. 6 Nm or 10 Nm
Operating voltage:	230 V ~ 50/60 Hz, 2,3 VA or 24 V ~ 50/60 Hz, 1,6 VA
Protection type:	IP40
Protection class:	I
Adjustment range:	90°
Setting times	60 sec./90°, 150 sec./90°, 210 sec./90°
Connection:	Connecting terminal, connecting cable on request

Assembly kits & accessories

SM 3, SM 4, SM 5

	Article		Art. no.	
SM 3	Assembly kit1	Universal assembly kit	BS 1	
	Assembly kit 3	Centra-Compact, Wilo-Mix-RS 25/80	BS 3	
	Assembly kit 4	AXA, Viessmann DN 15-25, Wilo-Mix, Wilo	BS 4	
	Assembly kit 5	Landis & Stäfa, Elesta (G series), ESBE, Danfoss HRE..., PAW	BS 5	
	Assembly kit 9	WITA GFM, Centra ZR... and DR... series, Vaillant VRM 3 - VRM 4	BS 9	
	Assembly kit11	Centra DRU... series	BS 11	
	ACCESSORIES	Connecting cable 4 x 0.75 mm ² / Length = 2 m		S-Z 3/5 2K
Connecting cable 3. limit switch 4 x 0.75 mm ² / Length = 2 m			S-Z 33 2K	
3. limit switch (potential-free, pre-assembled) \swarrow 2 A			S-Z 33 E	
SM 4	Assembly kit41	WITA brass mixers, WITA grey cast iron mixers T20, T40, T60 (T60-32-SM4 10 Nm)	BS 41	
	Assembly kit42	Holter BR, Komschröder G3C+G4C, Ewers GG, KG, RG DN25-32 (DN40-50 10 Nm)	BS 42	
	Assembly kit 43	ESBE MG (DN15-32),G+F (DN20-40), Acaso Thermomix DxxS+CxxS (DN15-32) DxxAG+CxxAG (DN20-40) DxxK+CxxK (DN12-28)	BS 43	
	Assembly kit 43MK	Meibes Kompakt Edition 7	BS 43MK	
	Assembly kit 44	ESBE HG + H (DN 20-DN50) G+F (DN40-80), Acaso H3 + H 4 (DN 25)	BS 44	
	Assembly kit 45	L&G, L&S VBI (G) 31 (DN20-40) VBF21 (DN40-50 10Nm)	BS 45	
	Assembly kit 46	Honeywell Corona V_A (DN20-32) - (DN40-50 10Nm), Junkers DWM +VWM (DN20-32) - (DN40-50 10 Nm)	BS 46	
	Assembly kit 47	PAW 3+4 way MS -H - module heating series K 32-38 (DN 25-25) - module heating series K 32-38 (DN 32-50 10 Nm)	BS 47	
	Assembly kit 411	ESBE 3+4 way T +TM (DN20-32)	BS 411	
	Assembly kit 412	ESBE BIV (DN20-25) Acaso Thermomix A20G Dn20, A (DN20-32) AxxK (DN12-22)	BS 412	
	Assembly kit 413	Honeywell, Centra 4 way ZRK (DN20-40)	BS 413	
	Assembly kit 414	Honeywell, Centra sleeve design ZR -DR xxxA - DRxxG (DN15-Dn32 10 Nm)	BS 414	
	Assembly kit 415	Honeywell, Centra 3 way DRU (DN20-25)	BS 415	
	Assembly kit 416	Holter GD+GV (DN40-50 10 Nm) - GD+GV (DN15-32)	BS 416	
	Assembly kit 417	Holter GD+GV (DN15-32)	BS 417	
	Assembly kit 418	Mut MS mixer VMX (DN25) - VM3000 (DN25-32)	BS 418	
	Assembly kits for other brands are available on request			
	ACCESSORIES	3. limit switch with connecting cable (potential-free) 2 x 0.75 mm ² / Length = 2 m (for SM 4.10) \swarrow 2 A		S-Z43EZK
		3. limit switch with connecting cable (output voltage = operating voltage) for SM 4.10 R \swarrow 2 A		S-Z4R3E2K
	SM 5	Assembly kit 50	WITA brass mixers Minimix (6Nm), Maximix (10Nm), WITA grey cast iron mixers H and Bloc T20, T40, T60 (T60-32 10Nm)	BS 50
		Assembly kit 52	Holter series 3+4 way BR, Kromschröder G3C + G4, Ewers GG-KG-RG DN 25-32 (DN 40-50 10Nm)	BS 52
		Assembly kit 53	ESBE MG (DN 15-32), G+F (DN20-40), T+TM (DN20-32), BIV (DN20-25), Acaso/Thermomix DxxS + CxxS (DN15-32), DxxAG + CxxAG (DN20-40), DxxK + CxxK (DN12-28)	BS 53
		Assembly kit 54	PAW MS-H module range K32-38 (DN25), module range K32-38 (DN32-50 10Nm)	BS 54
Assembly kit 55		L&G, L&S, VBI (G) 31 (DN 20-40 - VBF21 (DN 40-50 10Nm)	BS 55	
Assembly kit 56		Honeywell Corona V_A (DN20-32) - (DN 40-50 10 Nm), Junkers DWM + VWM (DN20-32), (DN40-50 10 Nm)	BS 56	
Assembly kit 57		ESBE HG + H (DN20-50), Acaso H3 + H4 (DN25)	BS 57	
Assembly kit 58		Holter GD + GV (DN 15-32)	BS 58	
Assembly kit 59		Holter GD + GV (DN 40-50 10Nm)	BS 59	
Assembly kit 511		Mut MS mixer VMX (DN 25/VM 3000 (DN20-32)	BS 511	
ACCESSORIES		Connecting cable 4 x 0.75 mm ² / Length = 2 m		S-Z 3/5 2K
	Connecting cable 3. limit switch 3 x 0.75 mm ² / Length = 2 m		S-Z 53 2K	
	3. limit switch, potential-free (pre-assembled) \swarrow 2 A		S-Z 53 E	

Accessories can be pre-mounted on the mixer on request.



Range of servomotors

Article		Max. torque	Adjusting time / range	Operating voltage	Art. no.	
SM 3 	with universal assembly kit 1 (anti-blocking)	10 Nm	130 sec. / 90°	230 V ~ 50 Hz	S 31 120	
		10 Nm	210 sec. / 90°	230 V ~ 50 Hz	S 31 130	
	without universal assembly kit (anti-blocking)	10 Nm	130 sec. / 90°	230 V ~ 50 Hz	S 30 120	
		10 Nm	210 sec. / 90°	230 V ~ 50 Hz	S 30 130	
SM 4.6 	with assembly kit 41 for WITA brass mixers	6 Nm	60 sec. / 90°	230 V ~ 50 Hz	S 41 010	
		6 Nm	150 sec. / 90°	230 V ~ 50 Hz	S 41 020	
		6 Nm	210 sec. / 90°	230 V ~ 50 Hz	S 41 030	
		6 Nm	60 sec. / 90°	24 V ~ 50 Hz	S 41 012	
		6 Nm	150 sec. / 90°	24 V ~ 50 Hz	S 41 022	
		6 Nm	210 sec. / 90°	24 V ~ 50 Hz	S 41 032	
	without assembly kit	6 Nm	60 sec. / 90°	230 V ~ 50 Hz	S 40 010	
		6 Nm	150 sec. / 90°	230 V ~ 50 Hz	S 40 020	
		6 Nm	210 sec. / 90°	230 V ~ 50 Hz	S 40 030	
		6 Nm	60 sec. / 90°	24 V ~ 50 Hz	S 40 012	
		6 Nm	150 sec. / 90°	24 V ~ 50 Hz	S 40 022	
		6 Nm	210 sec. / 90°	24 V ~ 50 Hz	S 40 032	
SM 4.10 	with assembly kit 41 for WITA brass mixers	10 Nm	150 sec. / 90°	230 V ~ 50 Hz	S 41 120	
		10 Nm	210 sec. / 90°	230 V ~ 50 Hz	S 41 130	
		10 Nm	150 sec. / 90°	24 V ~ 50 Hz	S 41 122	
		10 Nm	210 sec. / 90°	24 V ~ 50 Hz	S 41 132	
	without assembly kit	10 Nm	150 sec. / 90°	230 V ~ 50 Hz	S 40 120	
		10 Nm	210 sec. / 90°	230 V ~ 50 Hz	S 40 130	
		10 Nm	150 sec. / 90°	24 V ~ 50 Hz	S 40 122	
		10 Nm	210 sec. / 90°	24 V ~ 50 Hz	S 40 132	
SM 4.10 R 	with assembly kit 41 for WITA brass mixers	10 Nm	150 sec. / 90°	230 V ~ 50 Hz	S 41 R 120	
		10 Nm	210 sec. / 90°	230 V ~ 50 Hz	S 41 R 130	
		10 Nm	150 sec. / 90°	24 V ~ 50 Hz	S 41 R 122	
		10 Nm	210 sec. / 90°	24 V ~ 50 Hz	S 41 R 132	
	without assembly kit	10 Nm	150 sec. / 90°	230 V ~ 50 Hz	S 40 R 120	
		10 Nm	210 sec. / 90°	230 V ~ 50 Hz	S 40 R 130	
		10 Nm	150 sec. / 90°	24 V ~ 50 Hz	S 40 R 122	
		10 Nm	210 sec. / 90°	24 V ~ 50 Hz	S 40 R 132	
SM 5 	with assembly kit 50 for WITA brass mixers H and Minimax	6 Nm	60 sec. / 90°	230 V ~ 50 Hz	S 51 010	
		6 Nm	150 sec. / 90°	230 V ~ 50 Hz	S 51 020	
		6 Nm	210 sec. / 90°	230 V ~ 50 Hz	S 51 030	
		6 Nm	60 sec. / 90°	24 V ~ 50 Hz	S 51 012	
		6 Nm	150 sec. / 90°	24 V ~ 50 Hz	S 51 022	
		6 Nm	210 sec. / 90°	24 V ~ 50 Hz	S 51 032	
	with assembly kit 50 for WITA grey cast iron and H mixers and Blocs T 20, T 40, T 60	10 Nm	60 sec. / 90°	230 V ~ 50 Hz	S 51 110	
		10 Nm	150 sec. / 90°	230 V ~ 50 Hz	S 51 120	
		10 Nm	210 sec. / 90°	230 V ~ 50 Hz	S 51 130	
		10 Nm	60 sec. / 90°	24 V ~ 50 Hz	S 51 112	
		10 Nm	150 sec. / 90°	24 V ~ 50 Hz	S 51 122	
		10 Nm	210 sec. / 90°	24 V ~ 50 Hz	S 51 132	
	without assembly kit	6 Nm	60 sec. / 90°	230 V ~ 50 Hz	S 50 010	
		6 Nm	150 sec. / 90°	230 V ~ 50 Hz	S 50 020	
		6 Nm	210 sec. / 90°	230 V ~ 50 Hz	S 50 030	
		6 Nm	60 sec. / 90°	24 V ~ 50 Hz	S 50 012	
		6 Nm	150 sec. / 90°	24 V ~ 50 Hz	S 50 022	
		6 Nm	210 sec. / 90°	24 V ~ 50 Hz	S 50 032	
		without assembly kit	10 Nm	60 sec. / 90°	230 V ~ 50 Hz	S 50 110
			10 Nm	150 sec. / 90°	230 V ~ 50 Hz	S 50 120
10 Nm	210 sec. / 90°		230 V ~ 50 Hz	S 50 130		
10 Nm	60 sec. / 90°		24 V ~ 50 Hz	S 50 112		
10 Nm	150 sec. / 90°		24 V ~ 50 Hz	S 50 122		
10 Nm	210 sec. / 90°		24 V ~ 50 Hz	S 50 132		